

Micron Caliper

S_Cal EVO BT μ m

DESCRIPTION

MICRON

- **Integrated Bluetooth® Smart data transmission**
- New extra-large micron display
- Programmable button according to your needs
- Water protected for heavy-duty work with coolants and lubricants, protection rating IP67 according to IEC 60529,
- Automatic wake-up by moving the electronic on his frame. (Absolute System S.I.S)
- Sleeping mode after 20 min. of no use. (Absolute System S.I.S)
- Position memorized in sleeping mode, **Absolute System S.I.S***
- Maximum speed of displacement : 2.5 m/sec
- Mechanical frame in stainless steel, hardened and grinded
- Great comfort of use thanks to its ergonomic frame
- Thumb wheel on request (see accessories)

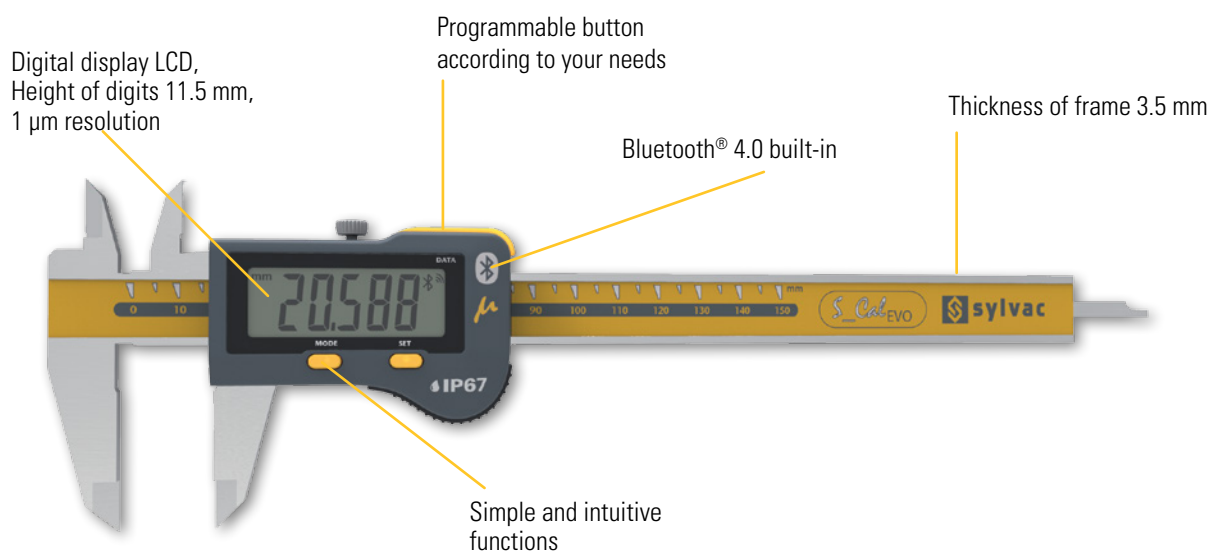

SIS Smart Inductive System

WATER RESISTANT

IP67

4 μ m repeatability



* SIS description on page 5

Micron Caliper

S_Cal EVO BT μ m

DIMENSIONAL DRAWING

MICRON

A

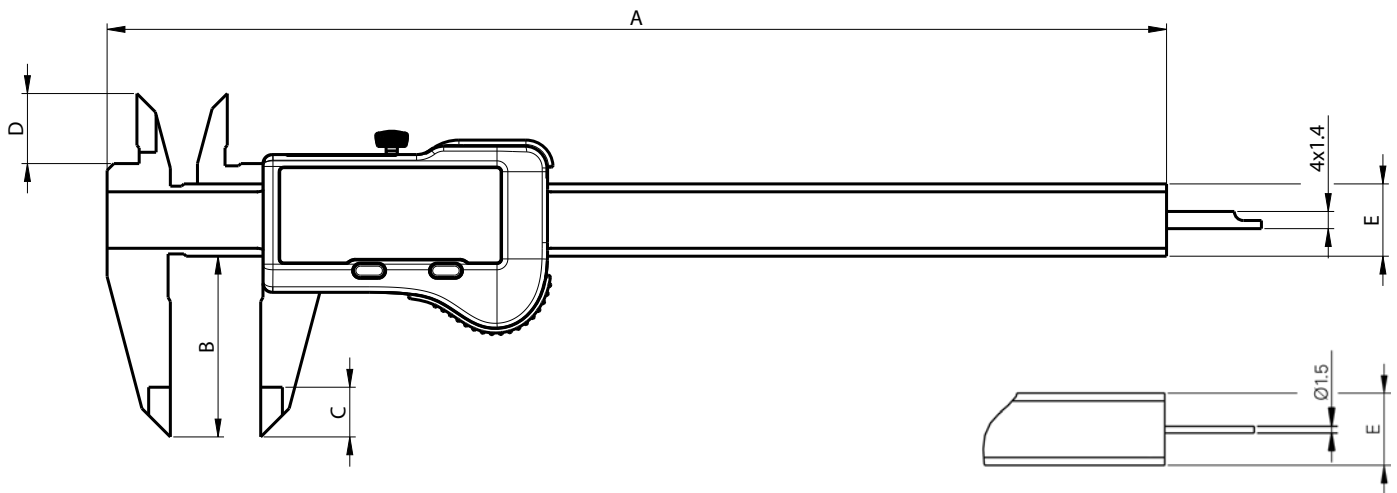

TECHNICAL SPECIFICATIONS

		810.9506	810.9516
Measuring range	mm	150	150
Max. Error G	μ m	15 ¹⁾	15 ¹⁾
A	mm	234.5	234.5
B	mm	40	40
C	mm	11	11
D	mm	16	16
E	mm	16 x 3.5	16 x 3.5
Depth rod	mm	4 x 1.4	Ø 1.5
Protection rating according to IEC 60529		IP67	IP67
Connection		Built-in BLUETOOTH® 4.0*	
Functions		Zero setting, Preset (max 999.99), mm/inch, Hold, Data	
Smart Inductive Sensor		●	

¹⁾ > 100 mm : 30 μ m / DIN 862

*** Up to 8 instruments connected per dongle #981.7100**
More informations on How to use Bluetooth® leaflet SYL_1401_EN_BT