

## DESCRIPTION

BLUETOOTH®

- **Integrated Bluetooth® Smart data transmission**
- New extra-large display
- Programmable button according to your needs
- Water protected for heavy-duty work with coolants and lubricants, protection rating IP67 according to IEC 60529,
- Automatic wake-up by moving the electronic on his frame. (Absolute System S.I.S)
- Sleeping mode after 20 min. of no use. (Absolute System S.I.S)
- Position memorized in sleeping mode, **Absolute System S.I.S\***
- Maximum speed of displacement : 2.5 m/sec
- Mechanical frame in stainless steel, hardened and grinded
- Great comfort of use thanks to its ergonomic frame
- Thumb wheel on request (see accessories)

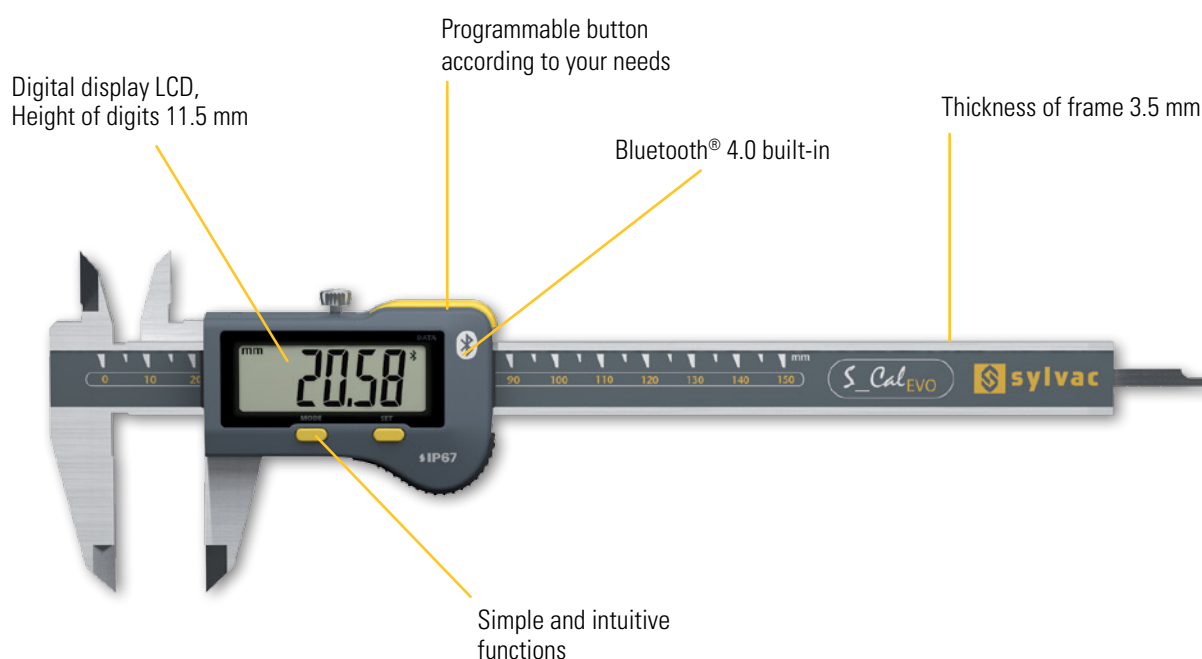

**Bluetooth® data transmission and IP67 protection rating!**

**SIS** Smart Inductive System

WATER RESISTANT

**IP67**

\* SIS description on page 5



# Caliper

# S\_Cal EVO BT

## DIMENSIONAL DRAWING

## BLUETOOTH®

A

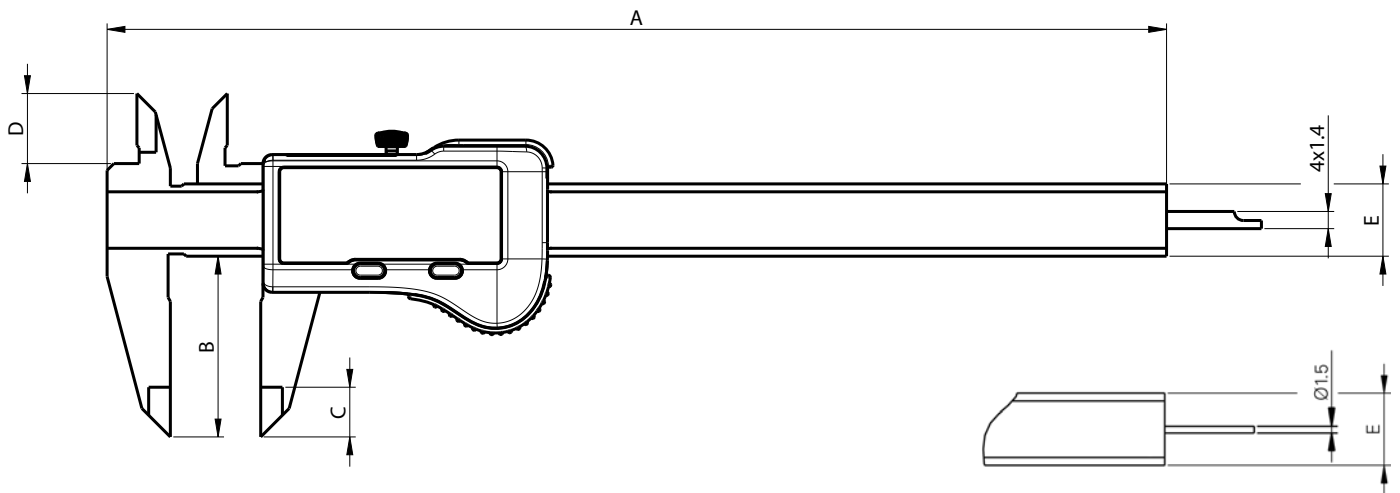

## TECHNICAL SPECIFICATIONS

		810.1506	810.1516	810.1526	810.1536
Measuring range	mm	150	150	200	300
Max. Error G	µm	20 <sup>1)</sup>	20 <sup>1)</sup>	30	30
A	mm	234.5	234.5	290.5	388
B	mm	40	40	50	64
C	mm	11	11	14	14
D	mm	16	16	19	19
E	mm	16 x 3.5	16 x 3.5	16 x 3.5	16 x 4
Depth rod	mm	■ 4 x 1.4	Ø 1.5	■ 4 x 1.4	---
Protection rating according to IEC 60529		IP67			
Connection		Built-in BLUETOOTH® 4.0*			
Functions		Zero setting, Preset (max 999.99), mm/inch, Hold, Data			
Smart Inductive Sensor		●			

<sup>1)</sup> > 100 mm : 30 µm / DIN 862

**\* Up to 8 instruments connected per dongle #981.7100**  
More informations on How to use Bluetooth® leaflet SYL\_1401\_EN\_BT