

# Neck Caliper

## Series 536

These neck calipers enable measurements in hard to reach places.  
They offer you the following benefits:

- You can measure wall thickness inside bores and recesses.

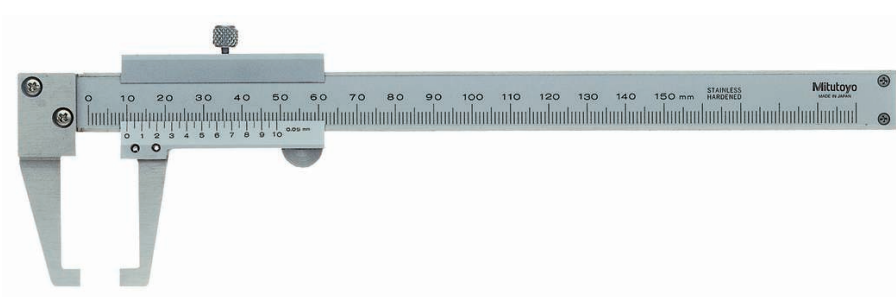

536-151

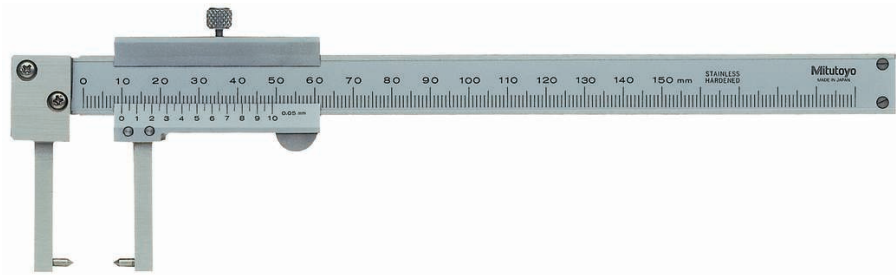

536-152  
Point jaw type

### Metric

No.	Range [mm]	Mass [g]
536-151	0-150	140

### Metric

#### Point jaw type

No.	Range [mm]	L [mm]	a [mm]	b [mm]	c [mm]	d [mm]	e [mm]	Mass [g]
536-152	0-150	229	38	5	5	16	2	140

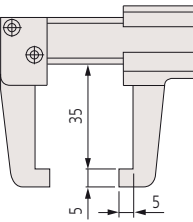

536-151

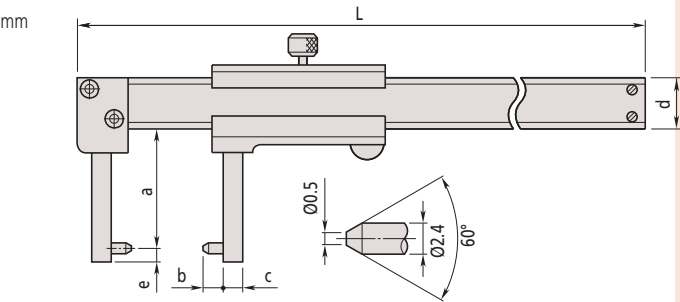

536-152  
Point jaw type

### Specifications

Accuracy	±0,05 mm
Graduation	0,05mm
Delivered	In a case

